

## Modular Cooking Range Line 200 mm - 1 Well Electric Fryer 9 liter with oil pump

ITEM # \_\_\_\_\_

MODEL # \_\_\_\_\_

NAME # \_\_\_\_\_

SIS # \_\_\_\_\_

AIA # \_\_\_\_\_



**285003 (ZXFRPB1BWQ)** 9lt electric fryer with 1 well, 1 basket, oil pump and warning led

**285005 (ZXFREB1BWQ)** 9lt electric fryer with 1 well, 1 basket, oil pump and warning led

### Short Form Specification

#### Item No.

Electric freestanding fryer with deep-drawn well is ideal for kitchens needing a versatile, compact, efficient but high productivity unit capable of cooking numerous portions time after time. The well layout, heating elements layout and the "eco" mode, require a minimum amount of oil and guarantee long oil life. Made in stainless steel. 4-position tilting elements to ease cleaning and use. Oil pump.

### Main Features

- All major compartments located in front of unit for ease of maintenance.
- IP24 protected.
- Overheat protection thermostat as standard on all units.
- Thermostatic regulation of oil temperature up to a maximum of 185 °C.
- Oil drains through a tap into a drainage container positioned under the well.
- Supplied as standard with 1 basket and 1 right side door for cupboard.
- Deep drawn well.
- Internal high efficiency tilting heating elements for high productivity and ease of cleaning of internal well.
- Integrated s/s oil filter.
- Oil pump timer for temporized filtration to be set up to 5 minutes.
- Control knobs positioned behind the door.
- Unit delivered with four 50 mm legs in stainless steel as standard.
- 4-lights display to indicate equipment under voltage, heaters on in "eco" mode, heaters on in "fry" mode, the unit is in overheating protection mode.

### Construction

- Interior of well with rounded corners for ease of cleaning.
- One piece pressed 1.5 mm work top in Stainless steel.
- Exterior panels in Stainless steel with Scotch Brite finish to meet the highest hygiene standards.
- The unit is designed for freestanding installation having external frame closed on sides, back and bottom.
- A bracket for wall mounting installation is provided as standard.
- Folding lid with storage in the door.
- The V-shaped well is made of two pieces of pressed stainless steel that are seamlessly laser-welded. (only for 285005)
- Unit is 60 cm deep to give a compact working area and reduced footprint.

### Sustainability

- Eco function switches the unit in stand-by mode to save energy. Fast temperature recovery to restart frying in less than one minute.
- This model is compliant with Swiss Energy Efficiency Ordinance (730.02).

### Included Accessories

- 1 of Basket for 9 lt fryer PNC 206390
- 1 of Stainless steel oil collecting filter for 9 lt fryer PNC 206393

### Optional Accessories

- Basket for 9 lt fryer PNC 206390
- Connecting kit for 9 lt fryer PNC 206391

APPROVAL: \_\_\_\_\_



## Modular Cooking Range Line 200 mm - 1 Well Electric Fryer 9 liter with oil pump

- Fabric oil collecting filter for 9 lt fryer PNC 206392
- Stainless steel oil collecting filter for 9 lt fryer PNC 206393
- Perforated fish plate for 9 lt fryers PNC 206394
- Kit of feet support for 2 modules of 200mm fryers PNC 206438
- Kit of feet support for 3 modules of 200mm fryers PNC 206439
- Kit of feet support for 4 modules of 200mm fryers PNC 206440
- Stainless steel oil large filter for 9lt fryer PNC 206443



### Modular Cooking Range Line 200 mm - 1 Well Electric Fryer 9 liter with oil pump

The company reserves the right to make modifications to the products without prior notice. All information correct at time of printing.

2025.03.18

**Front**

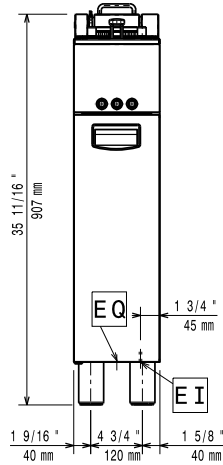

**Side**

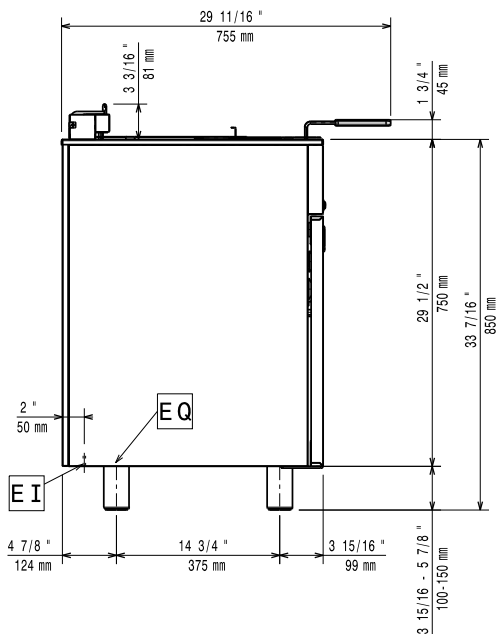

**EI** = Electrical inlet (power)  
**EQ** = Equipotential screw

**Top**

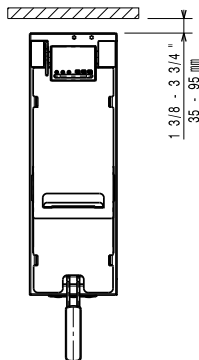

**Electric**

**Supply voltage:**

**285003 (ZXFRPB1BWQ)** 240 V/1 ph/50/60 Hz

**285005 (ZXFREB1BWQ)** 415 V/3N ph/50/60 Hz

**Rated amps:**

**285003 (ZXFRPB1BWQ)** 30.8 A

**285005 (ZXFREB1BWQ)** 17.8 A

**Total Watts:**

7.4 kW

**Key Information:**

<b>Number of wells:</b>	1
<b>Usable well dimensions (width):</b>	170 mm
<b>Usable well dimensions (height):</b>	330 mm
<b>Usable well dimensions (depth):</b>	500 mm
<b>Well capacity:</b>	7 lt MIN; 9 lt MAX
<b>Thermostat Range:</b>	90 °C MIN; 185 °C MAX
<b>External dimensions, Width:</b>	200 mm
<b>External dimensions, Depth:</b>	600 mm
<b>External dimensions, Height:</b>	930 mm
<b>Net weight:</b>	35 kg

- Integrated oil filter
- Oil pump

**Modular Cooking Range Line  
200 mm - 1 Well Electric Fryer 9 liter with oil pump**

The company reserves the right to make modifications to the products without prior notice. All information correct at time of printing.